

Lumiglas luminaires stainless steel type USL15-LED and USL35-LED

ISO 9001
DATA SHEET 02-0155 11/09

For mounting on sight glass fittings

Sight glass luminaire for universal use, ideal either as a light/sight port combination (single-flange version) or for configurations with separate sight glass and light port (dual-flange version).

The specific advantages of Lumiglas LED technology:

- Insensitive to vibration
- Long service life and high operational safety
- Continuous operations up to about 50,000 hours
- The optimal solution wherever fittings are difficult to access
- No heat radiation in the light aperture (cold light)
- No additional heat which is undesirable for chemical and/or biological processes

Compact design:

Glare-free illumination; compatible with circular sight glass fittings, in-line sight glasses and area lighting.

For use with sight glass fittings

This compact sight port luminaire is applicable for combination sight/light port (single port version) or separate light and sight port (dual-port version) with sight glass styles as follows:

- Circular weld-on sight glass series DIN 28120 starting at DN40
- Circular sight glass series ANSI Bolt-On starting at 2"
- Visual Flow Indicators starting at size 1"
- Circular weld-neck series MV starting at DN 50
- Sanitary clamp connection series MetaClamp® starting at 1"

Applications:

The optimum solution in the pharmaceutical, chemical and food processing industries. Ideal for illuminating bioreactors, laboratory mixers and filters as well as the interiors of boilers, tanks, agitators, separators, pipes and other – usually sealed – vessels in operating environments that are not potentially explosive.

Protection:

Dust and waterjet tight to IP 65 per EN 60 529/ DIN VDE 0470, Part 1 and NEMA Types 4 & 4X

Operating conditions:

Independent of the pressure/vacuum inside the vessel

Under no circumstances should Lumiglas luminaires be used for sealing vessel openings, in place of a suitable sight glass fitting.

Electrical data:

- Convenient electrical link-up: The Lumiglas luminaire is equipped with a factory-mounted connecting cable (3 m)
- Operating voltage: 12, 24, 120 and 230 V
- Power consumption: approx. 11 W



Stainless steel Lumiglas luminaire USL15-LED



Stainless steel Lumiglas luminaire USL35-LED

Parts, construction and materials:

- Connecting cable: 3 m (3 x 0.75 mm²)
- Weight: about 0.85 kg
- Mounting parts in 1.4301 stainless steel: hinged bracket, Part No. 0527.008.00 (included in scope of supply) or male adapter flange for attachment to screw-type sight glass fitting, Part No. 1356.010.00 (to be ordered separately)

Lumiglas stainless steel luminaire type USL35-LED:

As a result of adapting the light aperture, this variant is particularly suitable for applications in aseptic and sterile environments.

Excellent results are assured by using sight glasses fused to a metal frame (METAGLAS[®]) and the BioControl (NEUMO) range of flanges. METAGLAS[®] functions optimally with clamp fittings (METACLAMP[®]), but also using NA-Connect[™] technology.

The following methods of installing and fastening Lumiglas luminaires in sterile environments have been optimized in practice:

- The luminaire is fitted over the flared male insert on the cover flange, where it is secured in place. An O-ring designed between the two effectively seals the closure to the light port.
- A popular alternative is to secure the luminaire using a clamped joint on an adapted flange to DIN 32676/ISO 2852. The attachment to the flange is by means of a special ring construction with a sight glass fused to the metal ring).
- This metal-glass ring is equipped with an additional insert over which the Lumiglas luminaire is mounted. An O-ring forms the seal between the two; the required sealing pressure is provided by tightening the clamp.

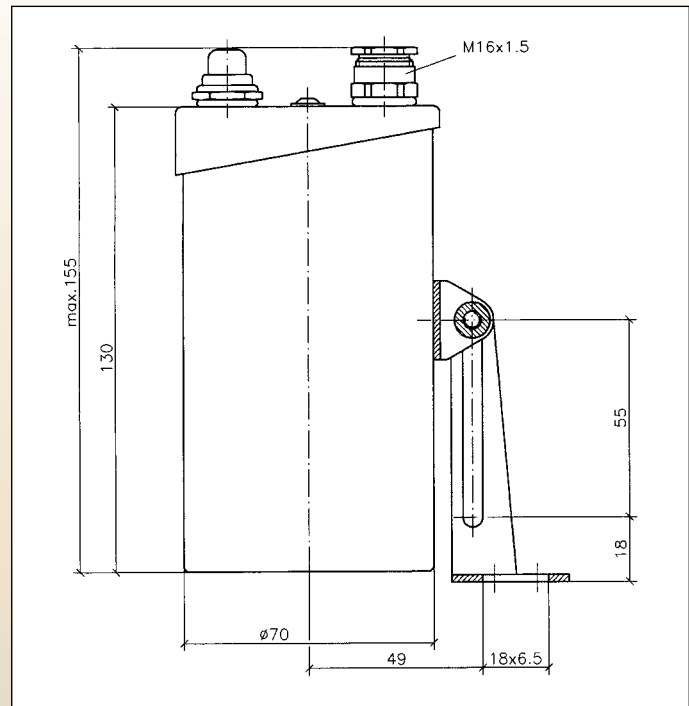

Dimensions for stainless steel Lumiglas luminaire USL15-LED

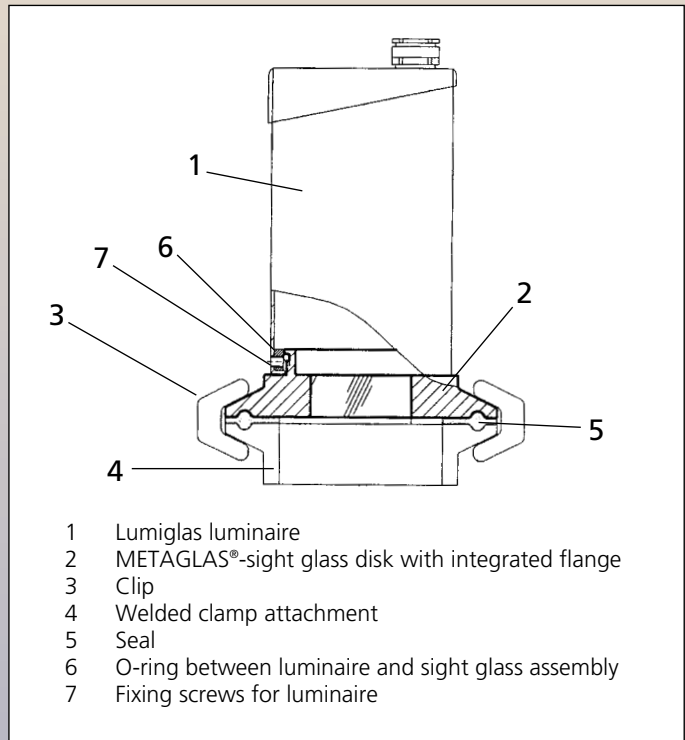

Stainless steel Lumiglas luminaire USL35-LED on a sight glass fused into a metal frame; suitable for sanitary clamp connections (METACLAMP[®])

All dimensions in mm unless stated otherwise. Subject to change without prior notice.